

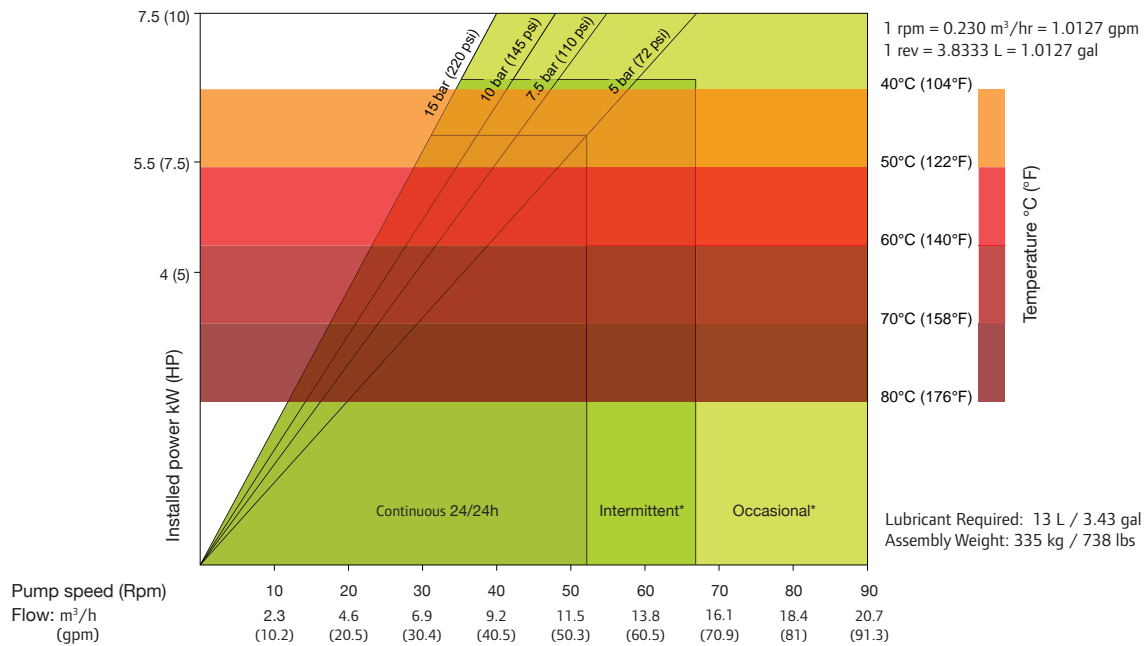

# ALH65

## Data Sheet



\*Intermittent use : minimum one hour stop after 2 hours run / \*Occasional use : maximum one hour a day

SHOE SHIMMING TABLE - ALH65		
Pressure bar (psi)	Speed - Rpm	Number of shims* - thickness 0.5 mm (0.019 in)
ΔP ≤ 5 (72.5)	0 to 30	0
	30 to 90	0
5 (72.5) ≤ ΔP ≤ 7.5 (108.75)	0 to 30	2
	30 to 55	1
7.5 (108.75) ≤ ΔP ≤ 10 (145)	0 to 30	3
	30 to 47.5	2
10 (145) ≤ ΔP ≤ 15 (217.5)	0 to 30	4
	30 to 40	3

\*Remove one shim if temperature exceeds 60° Celsius (140° Fahrenheit)

### DIMENSIONS

mm (Inch)

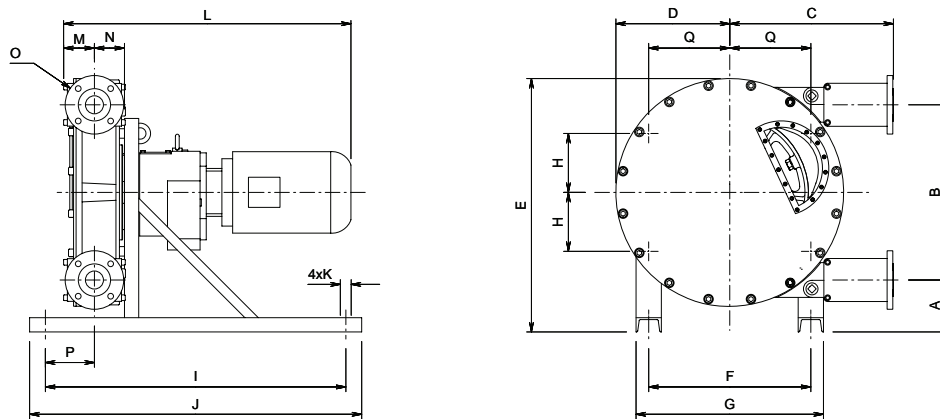

TYPE	A	B	C	D	E	F	G	H	I	J	K	L	M	N	O	P	Q
ALH65	164 (6.4)	554 (21.8)	522 (20.5)	360 (14.2)	801 (31.5)	513 (20.2)	593 (23.3)	257 (10.1)	950 (37.4)	1050 (41.3)	4xø19 (4xø0.7)	-	99.5 (3.91)	87.6 (3.4)	DN65 PN16 ANSI 2.5 in / 150#	148 (5.8)	186.5 (7.3)