

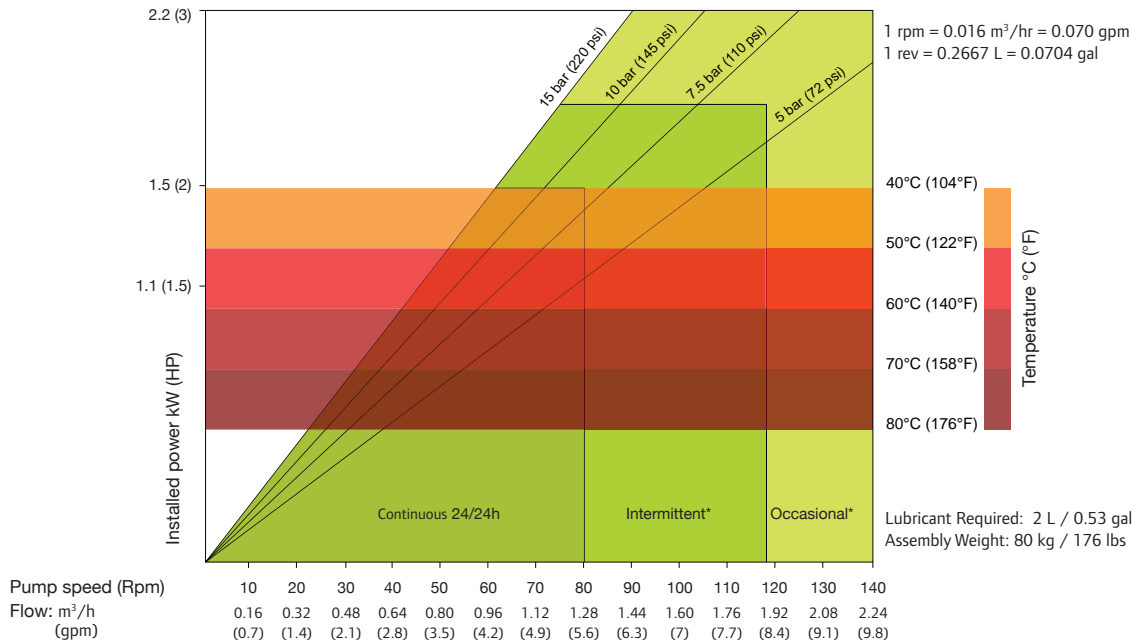

ALH25

Data Sheet



*Intermittent use : minimum one hour stop after 2 hours run / *Occasional use : maximum one hour a day

SHOE SHIMMING TABLE - ALH25		
Pressure bar (psi)	Speed - Rpm	Number of shims* - thickness 0.5 mm (0.019 in)
ΔP ≤ 5 (72.5)	0 to 40	0
	40 to 160	0
5 (72.5) ≤ ΔP ≤ 7.5 (108.75)	0 to 40	2
	40 to 125	1
7.5 (108.75) ≤ ΔP ≤ 10 (145)	0 to 40	3
	40 to 105	2
10 (145) ≤ ΔP ≤ 15 (217.5)	0 to 40	4
	40 to 90	3

*Remove one shim if temperature exceeds 60° Celsius (140° Fahrenheit)

DIMENSIONS

mm (Inch)

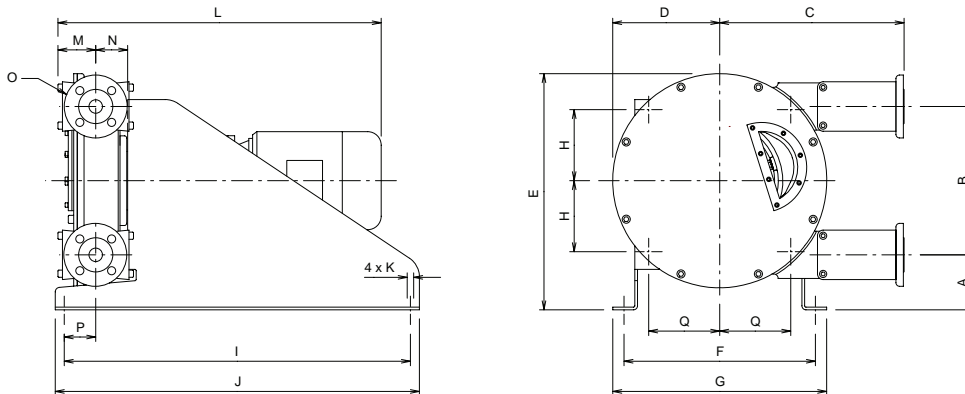

TYPE	A	B	C	D	E	F	G	H	I	J	K	L	M	N	O	P	Q
ALH25	95 (3.7)	262 (10.3)	356 (14.0)	134 (5.3)	430 (17)	307 (12.0)	347 (13.7)	110 (4.3)	520 (20.5)	550 (21.6)	4xø13 (4xø0.5)	-	62 (2.4)	62 (2.4)	DN25 PN16 ANSI 1 in / 150#	71 (2.8)	110 (4.3)