

SALES AND ENGINEERING DATA

PD03P-XXS-XXX AND PE03P-XXS-XXX 3/8" NON-METALLIC DIAPHRAGM PUMP

RATIO SERIES: 1:1

FLUID P.S.I. RANGE: 10 - 100

RELEASED: 2-17-06
REVISED: 12-17-21
(REV. H) S-1386

DIMENSIONAL DATA

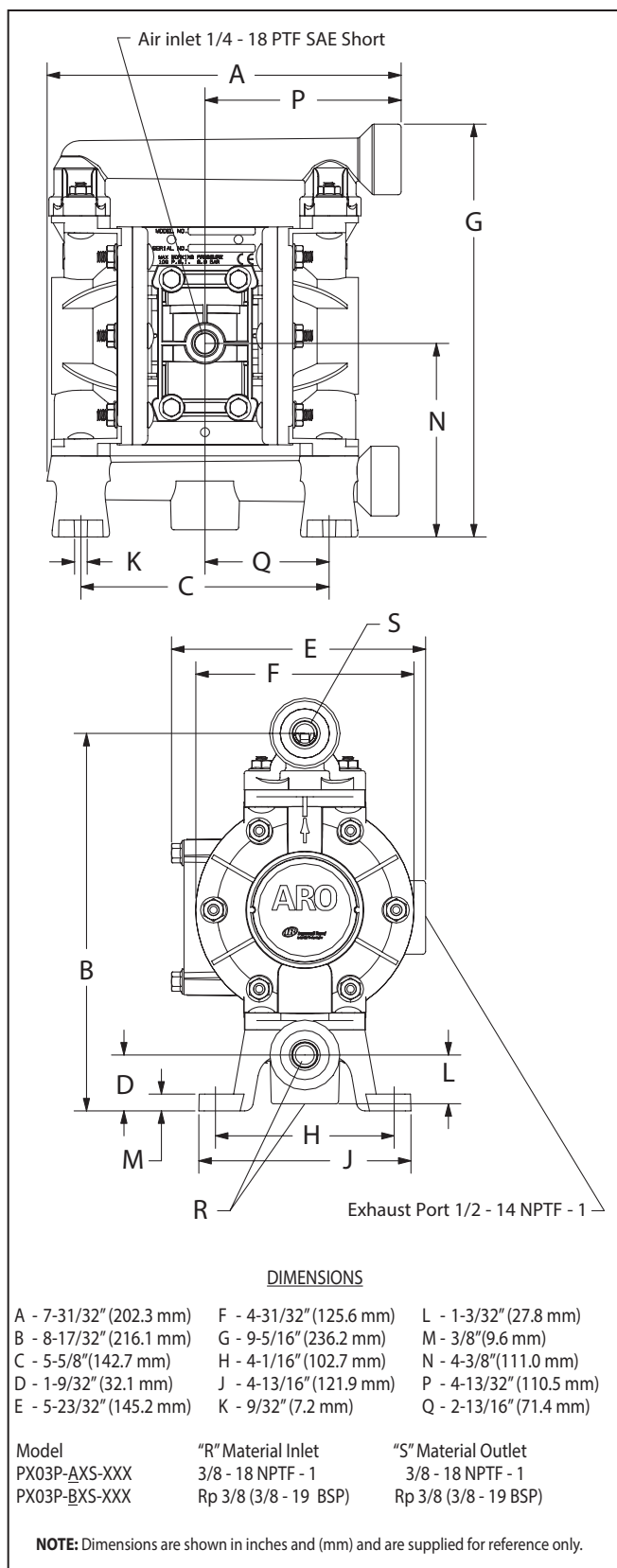

SPECIFICATIONS

| | |
|---|---|
| Model Series | PD03P-XXS-XXX PE03P-XXS-XXX |
| Pump Type | Non-Metallic, Air Operated, Double Diaphragm |
| Ratio | 1:1 |
| Material Inlet / Outlet (female) | |
| PX03P-AXS-XXX | 3/8 - 18 NPTF - 1 |
| PX03P-BXS-XXX | Rp 3/8 (3/8 - 19 BSP parallel) |
| Air Inlet (female) | 1/4 - 18 PTF SAE short |
| Air Exhaust (standard) | internal |
| (optional)(female) | 1/2 - 14 NPTF - 1 |
| Weight | |
| PX03P-XDS-XXX | 4.16 lbs (1.89 kgs) |
| PX03P-XES-XXX | 4.26 lbs (1.93 kgs) |
| PX03P-XKS-XXX | 4.50 lbs (2.04 kgs) |
| PX03P-XLS-XXX | 4.62 lbs (2.10 kgs) |
| PX03P-XPS-XXX | 3.44 lbs (1.56 kgs) |
| PX03P-XRS-XXX | 3.50 lbs (1.59 kgs) |
| Air Section Service Kit | 637428 |
| Fluid Section Service Kit | 637429-XX |

PX03P-XXS - X[X]X - C

637429 - [X]X

Diaphragm Material
Ball Material

EXAMPLE: Model #PD03P-ARS-SAA
Fluid Section Service Kit is 637429-AA

PERFORMANCE

| | |
|--|---------------------------------|
| Air Inlet Pressure Range | 10 - 100 psig (0.69 - 6.9 bar) |
| Maximum Material Inlet Pressure .. | 10 psig (0.69 bar) |
| Fluid Pressure Range | 10 - 100 psig (0.69 - 6.9 bar) |
| Maximum Flow Rate (flooded inlet) | |
| ball check | 10.6 gpm (40.1 lpm) |
| duckbill | 8.7 gpm (32.9 lpm) |
| Displacement / Cycle @ 100 psig | |
| ball check | 0.022 gal. (0.083 lit.) |
| duckbill | 0.018 gal. (0.068 lit.) |
| Maximum Particle Size - ball check .. | 1/16" dia. (1.6 mm) |
| duckbill | fibers |
| Maximum Temperature Limits (diaphragm / ball / seat material) | |
| Acetal | -20° to 180° F (-29° to 82° C) |
| E.P.R / EPDM | -60° to 280° F (-51° to 138° C) |
| Hytrel® | -20° to 180° F (-29° to 82° C) |
| Kynar® PVDF | 10° to 200° F (-12° to 93° C) |
| Neoprene | 0° to 200° F (-18° to 93° C) |
| Nitrile | 10° to 180° F (-12° to 82° C) |
| Polypropylene | 32° to 175° F (0° to 79° C) |
| Santoprene® | -40° to 225° F (-40° to 107° C) |
| PTFE | 40° to 225° F (4° to 107° C) |
| Viton® | -40° to 350° F (-40° to 177° C) |
| Noise Level @ 70 psig - 60 cpm | 72.7 dB(A) ^① |

① The pump sound pressure level has been updated to an Equivalent Continuous Sound Level (LA_{eq}) to meet the intent of ANSI S1.13-1971, CAGI-PNEUROP S5.1 using four microphone locations.

ACCESSORIES:
66073-1 Air Line Connection Kit
76763 Wall Mount Bracket

Dual Inlet/Dual Outlet Kits:
637442-1 (NPT Polypropylene)
637442-2 (NPT Acetal)



CCN 15255557



PERFORMANCE CURVES

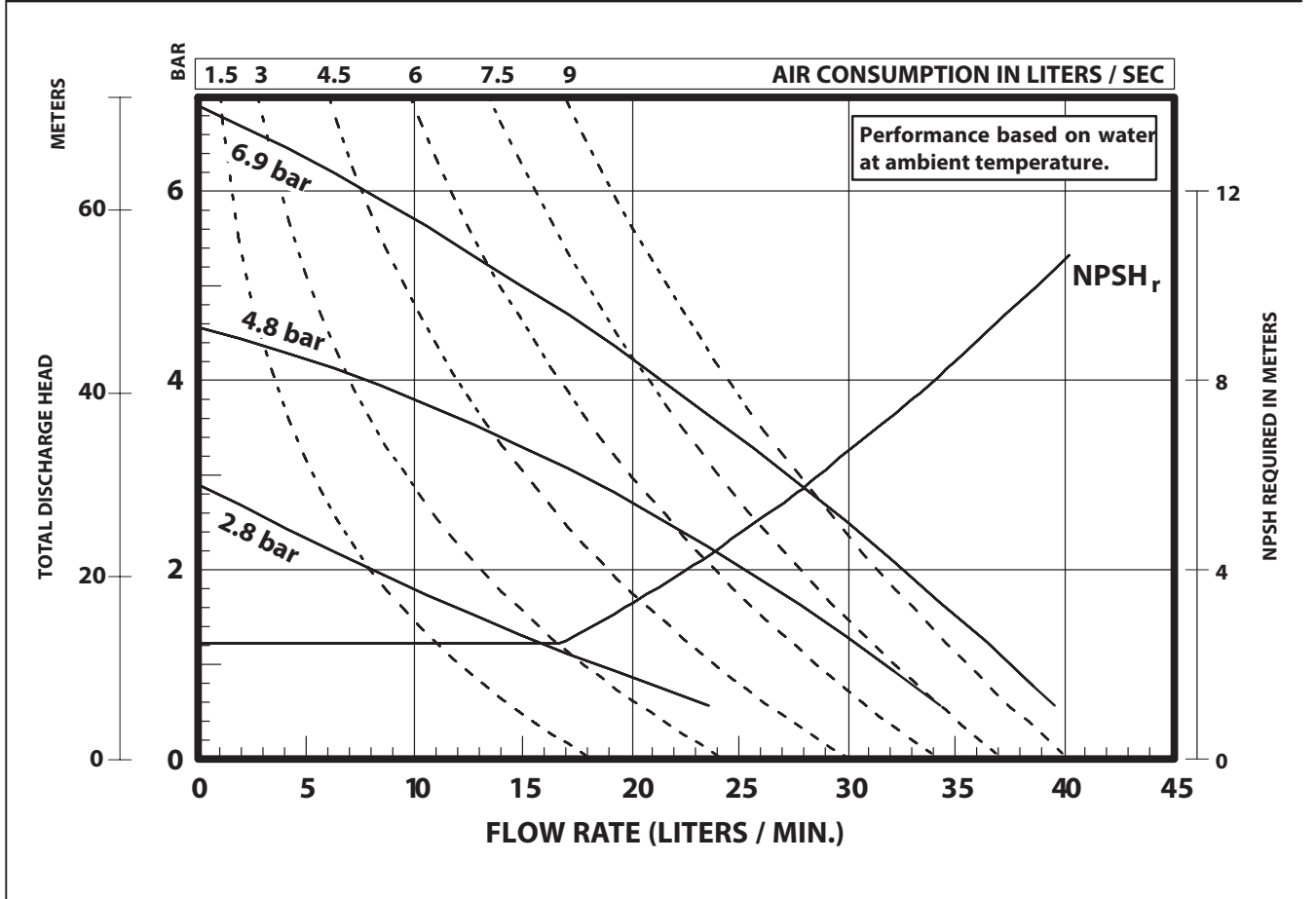
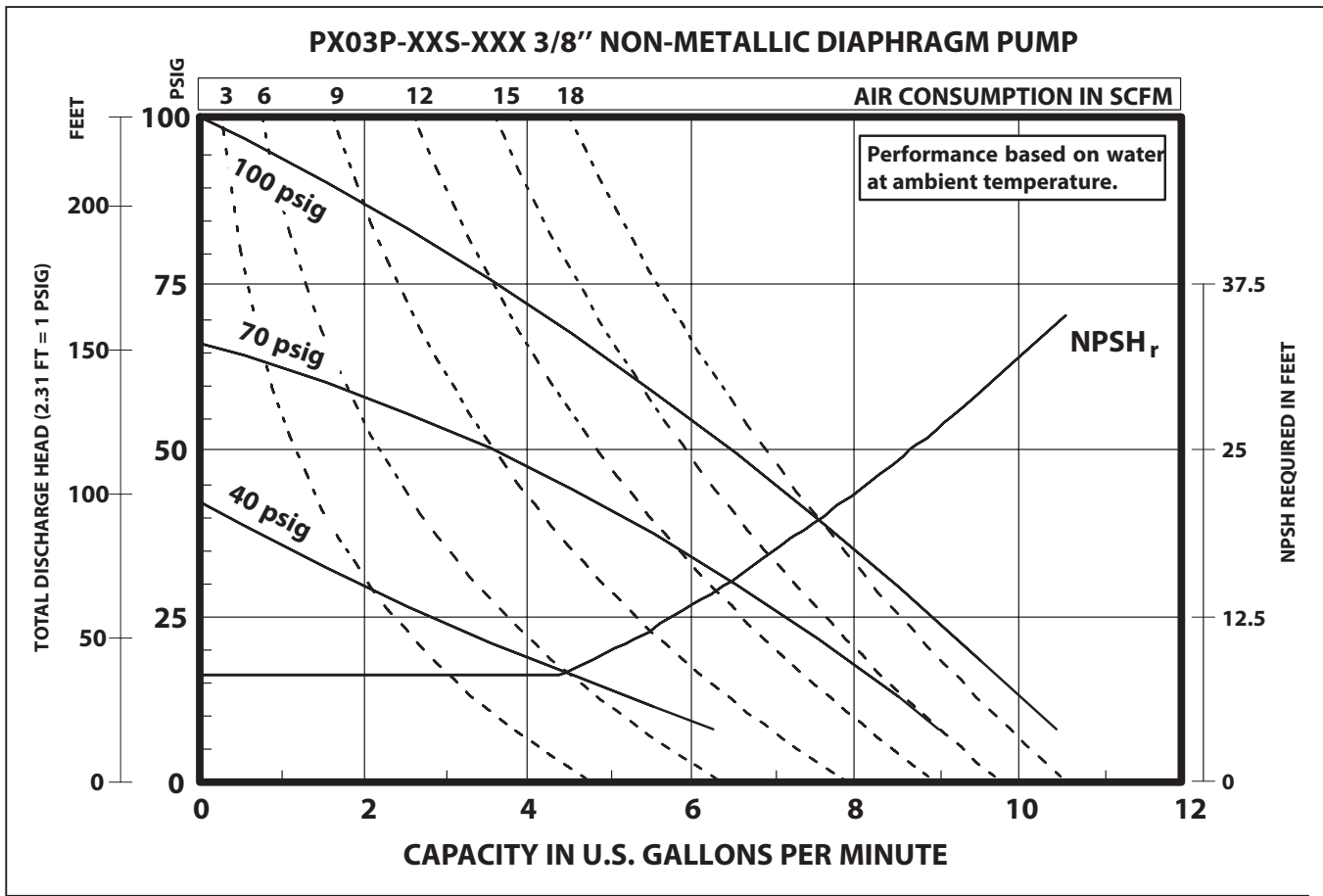

PERFORMANCE CURVES

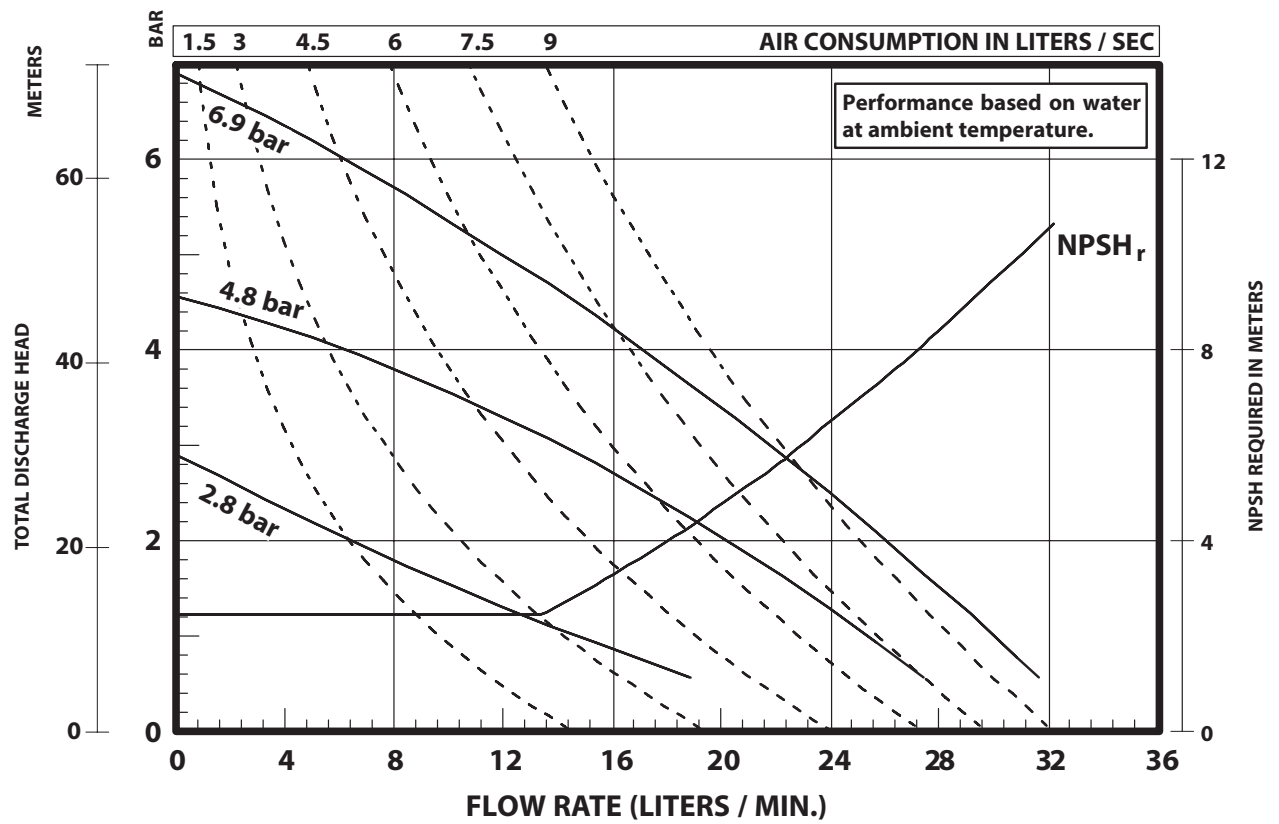
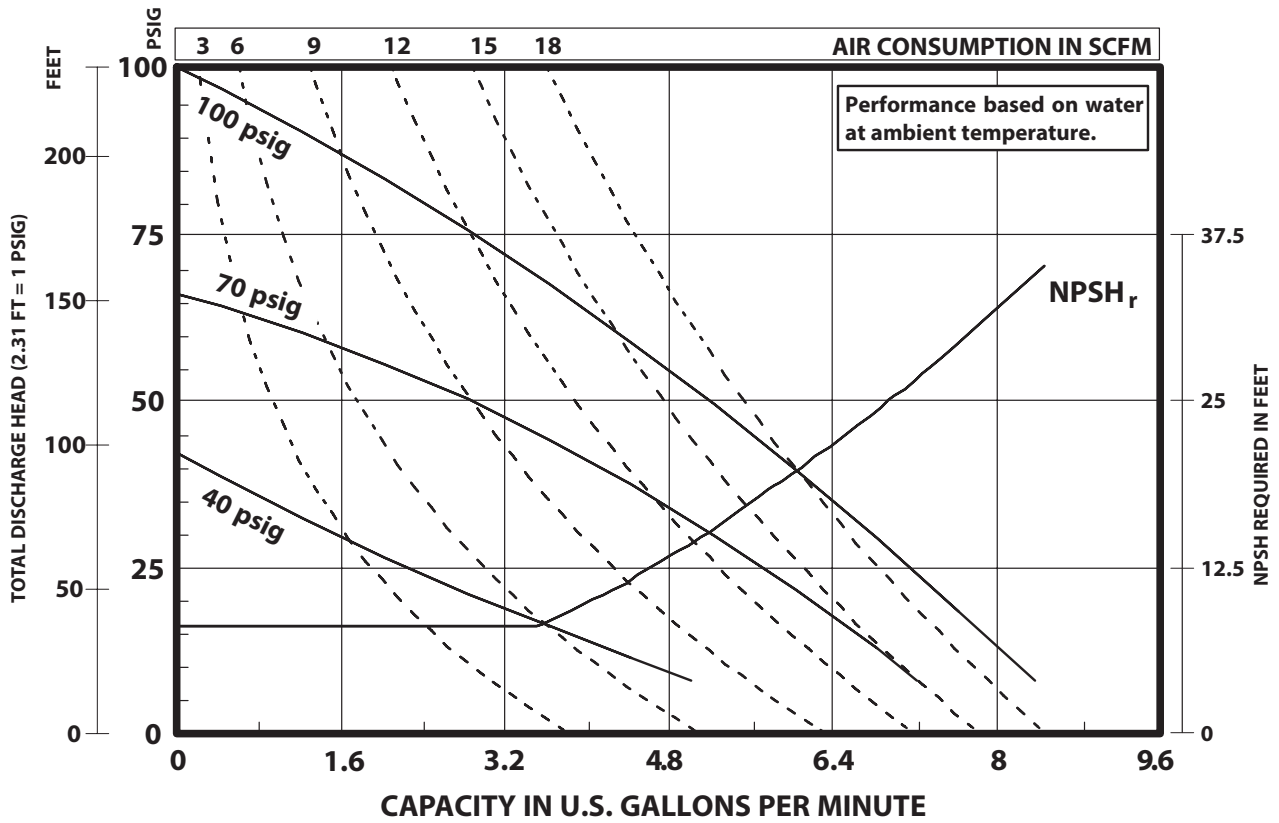

PE03P-XXS-XXX-XXEX and PE03P-XXS-XXX-XXFX 3/8" NON-METALLIC DIAPHRAGM PUMP



Illinois Location:
(847) 841-7867
860 Church Rd Elgin, IL 60120

Minnesota Location:
(651) 758-7867
330 Mill Bay South Suite
Afton, MN 55001

PumpSupplyInc.com



PUMP SUPPLY
INCORPORATED