

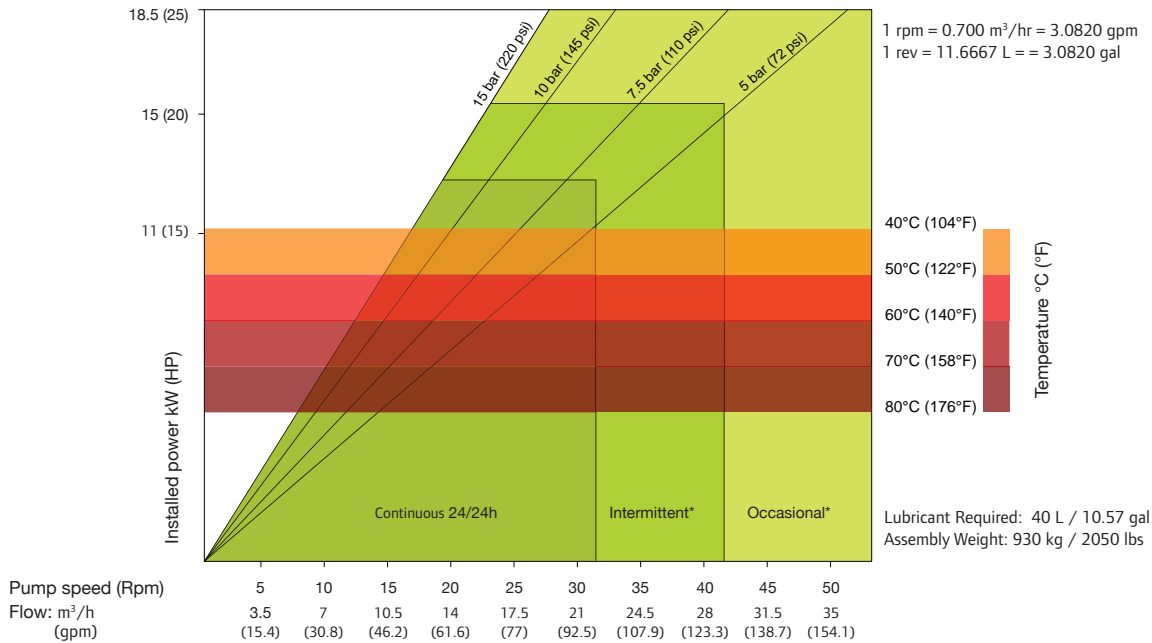

# ALH80

## Data Sheet



\*Intermittent use : minimum one hour stop after 2 hours run / \*Occasional use : maximum one hour a day

SHOE SHIMMING TABLE - ALH80		
Pressure bar (psi)	Speed - Rpm	Number of shims* - thickness 0.5 mm (0.019 in)
ΔP ≤ 5 (72.5)	0 to 20	0
	20 to 60	0
5 (72.5) ≤ ΔP ≤ 7.5 (108.75)	0 to 20	2
	20 to 47	1
7.5 (108.75) ≤ ΔP ≤ 10 (145)	0 to 20	3
	20 to 37	2
10 (145) ≤ ΔP ≤ 15 (217.5)	0 to 20	4
	20 to 31	3

\*Remove one shim if temperature exceeds 60° Celsius (140° Fahrenheit)

### DIMENSIONS

mm (Inch)

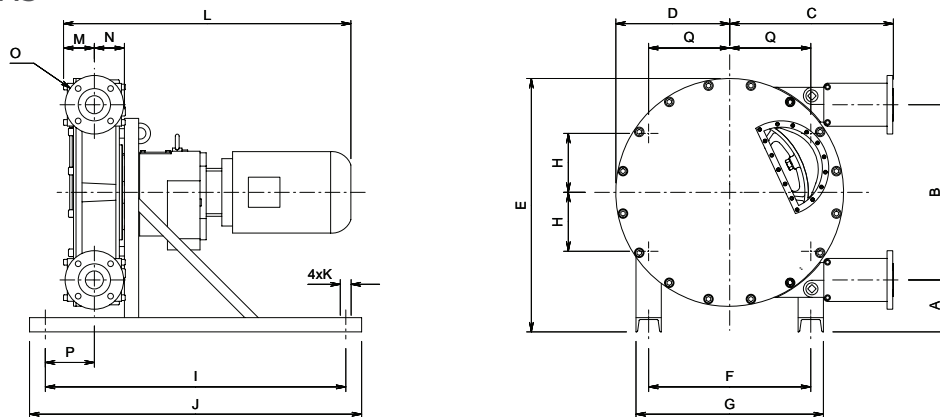

TYPE	A	B	C	D	E	F	G	H	I	J	K	L	M	N	O	P	Q
ALH80	266 (10.5)	876 (34.5)	803 (31.6)	561 (22.0)	1265 (49.8)	690 (27.2)	830 (32.3)	345 (13.6)	1300 (51.2)	1400 (55.1)	4xø27 (4xø1.0)	-	125 (4.9)	108.5 (4.3)	DN80 PN16 ANSI 3 in / 150#	202 (7.8)	345 (13.6)